

362.864.5

The
INCORPORATED HOSTELS

Associated with the Royal Free Hospital



Tenth
Annual Report

Accounts

and

List of Subscribers

for 1928-29



Regent's Park Hostel

62, Regent's Park Road, N.W. 1

Telephone: Primrose Hill 2839

Highbury Quadrant Hostel

20 & 22, Highbury Quadrant, N. 5

Telephones: North 0180
and North 4615

Pamphlet

363.
592
094
21
R07

The
INCORPORATED HOSTELS

Associated with the Royal Free Hospital.

Regent's Park Hostel :

62, Regent's Park Road,
N.W. 1.

Telephone : Primrose Hill 2839.

Highbury Quadrant Hostel :

20 & 22, Highbury Quadrant,
N. 5.

Telephone : North 0180.
and North 4615.

TENTH

Annual Report, Accounts, and
List of Subscribers for 1928-29.

PRINTED BY

J. DAVY & SONS, Ltd., 8-9, FRITH-STREET, LONDON, W. 1.

363.592060421 ROY

INCORPORATED HOSTELS.

Vice-Presidents.

THE VISCOUNTESS ST. CYRES. THE LADY SYDENHAM OF COMBE.
 THE LADY BERTHA DAWKINS. DR. JANE WALKER.
 MRS. ST. JOHN.

Committee of the Association.

Chairman—Sir Thomas Barlow, Bart., K.C.V.O.

Vice-Chairman—A. G. L. Gamlen, Esq.

Hon. Secretary—Miss B. d'Avigdor.

The Rt. Hon. the Earl of Ancaster.	Mrs. Julian Q. Henriques.
F. R. S. Balfour, Esq.	Mrs. Sidney Higgs.
Miss H. M. Beale.	Mrs. Mark Kerr.
Miss G. M. Bulman, R.R.C.	Miss E. Lucy.
Dr. Anne Campbell.	Professor Louisa McIlroy, D.Sc.
Sir Francis Champneys, Bt., M.D.	Arthur R. Moro, Esq.
Lady Codrington.	Miss A. Orred.
Miss E. Crowdy, C.B.E.	Walter Roch, Esq.
The Hon. Lady Darwin.	The Hon. Mrs. Walter Roch.
Miss B. M. Davidson.	Dr. Margaret Rorke.
The Lady Emmott.	Miss E. M. Royden.
Dr. Dorothy Hare, C.B.E., M.R.C.P.	Miss A. M. Smith.
Julian Q. Henriques, Esq.	

Executive Committees.

REGENT'S PARK HOSTEL :

Chairman—Dr. D. C. Hare.
 The Hon. Mrs. N. Barlow.
 Miss McEwan.
 Mrs. Arnold Paterson.
 The Hon. Mrs. Walter Roch.
 Miss E. M. Royden.
 Dr. Margaret Rorke.
 Mrs. Julian Smeathman.
 Miss. A. M. Smith.
 R. R. Garratt, Esq.,
Hon. Treasurer,
 Royal Free Hospital
 Gray's Inn Road, W.C. 1.
 Miss B. d'Avigdor, *Hon. Sec.*
 4, Pelham Crescent, S.W. 7.
Sister-in-Charge—Mrs. Bolton.
Bankers—
 Messrs. Lloyds Bank, Ltd.,
 Holborn Circus, E.C.

HIGHBURY QUADRANT HOSTEL :

Chairman—Miss B. d'Avigdor.
 The Lady Emmott.
 Dr. D. C. Hare.
 Mrs. Julian Q. Henriques.
 Mrs. Sidney Higgs.
 Miss A. M. Smith.
 Miss McEwan.
 Dr. A. Campbell, *Visiting*
Medical Officer.
 Dr. Margaret Rorke.
 R. R. Garratt, Esq.
 The Hon. Mrs. N. Barlow,
Hon. Treasurer,
 4, Gloucester Walk, W. 8.
 Mrs. Arnold Paterson, *Hon. Sec.,*
 5, Beaufort Mansions, Chelsea, S.W. 3.
Sister-in-Charge—Miss K. E. Noakes.
Bankers—
 Messrs. Lloyds Bank, Ltd.,
 Kensington High Street, W. 8.

Auditors—Messrs. Hardy, Hislop & Co., 119, Moorgate, E.C. 2.

3800172679

INCORPORATED HOSTELS.

AIMS.

The Incorporated Hostels are for the care of girls and women suffering from venereal diseases in an infective stage.

The patients are drawn chiefly from the Royal Free Hospital V.D. Clinic, and are selected by the Medical Officer to the Clinic; but cases from any part of London or the country may be received. (*See Rules for admission.*)

Most of the patients admitted to the Hostels are treated as out-patients at the Royal Free Hospital.

The aims of the Committee are :

1. Care and medical treatment of women suffering from venereal disease.
 - (a) Non-pregnant cases. Admitted to Regent's Park Hostel.
 - (b) Pregnant cases. Admitted to Highbury Quadrant Hostel.
 - (c) Mothers and babies. Admitted to Highbury Quadrant Hostel.
2. After-care of these patients when discharged from the Hostels, and medical supervision of the children.

The work is supplementary to that of the Hospital out-patients' clinic, as at present insufficient provision is made in general hospitals for the isolation and after-care of these infectious cases. The special daily treatment given at the Hostels, together with rest and good food, help to make hospital treatment more effective, and to shorten the course of the disease.

The greater number of those admitted are wage-earners : such as waitresses, domestic servants, factory workers, or clerks, who are, for the time being, unfitted to earn their living. They would not willingly enter a large institution, nor are they so ill as to need a bed in hospital. Conditions often make it impossible for the girl to stay at home, though the parents willingly contribute towards her expenses at a hostel. Whatever the circumstances, these girls all need help to start them on the road to recovery.

The Hostels are conducted on undenominational lines, but during their stay, every effort is made to help patients to moral, as well as to physical recovery, and to train them in the care of their children.

After-care is an integral part of the scheme, and great importance is attached to keeping in touch with patients over a considerable period of time. The keeping of records of the health and physical development of the children for some years forms an addition to the medical work carried on whilst they are inmates of the Hostel.

ACCOMMODATION.

REGENT'S PARK HOSTEL	15 Beds
62, Regent's Park Road, N.W.1.		
HIGHBURY QUADRANT HOSTEL	19 Beds
22, Highbury Quadrant, N.5.		
	20, Highbury Quadrant, N.5 (when ready)	14 Beds
		14 Cots

REGULATIONS AND CONDITIONS FOR ADMISSION.

1. Cases are admitted by the Medical Officer of the Royal Free Hospital Venereal Diseases Clinic, who attends at the Hospital (Out-patients) daily from 9.30 a.m.—7.30 p.m., and on Saturdays from 9.30 a.m.—12.30 p.m.

2. Only patients suffering from Venereal Disease in an infectious stage are eligible for admission.

3. Medical practitioners who are desirous of securing the admission of a patient to the Hostels are invited to refer the case to the Hospital Clinic with a note to the Medical Officer.

4. Patients from other hospital clinics in the district are admitted and arrangements made for them to continue under the care of their own Medical Officer. Applications for vacancies should be made to the Almoner, Royal Free Hospital, Gray's Inn Road, W.C.1.





5. The most suitable cases for admission to the Hostels are young girls. Married women, professional prostitutes, or remand cases are not usually suitable.

6. Patients are kept in the Hostels, if possible, until their condition becomes non-infectious, and suitable arrangements have been made for their return to work, or to their families.

7. No patient is refused on grounds of inability to pay, but the circumstances of patients are enquired into by the Almoner of the Royal Free Hospital. They are required to contribute towards the cost of their maintenance if in a position to do so.

Further information regarding the Hostels may be obtained on application to the Almoner, Royal Free Hospital, Gray's Inn Road, W.C.1, or to the Hon. Sec., 4, Pelham Crescent, S.W.7.

HIGHBURY QUADRANT HOSTEL



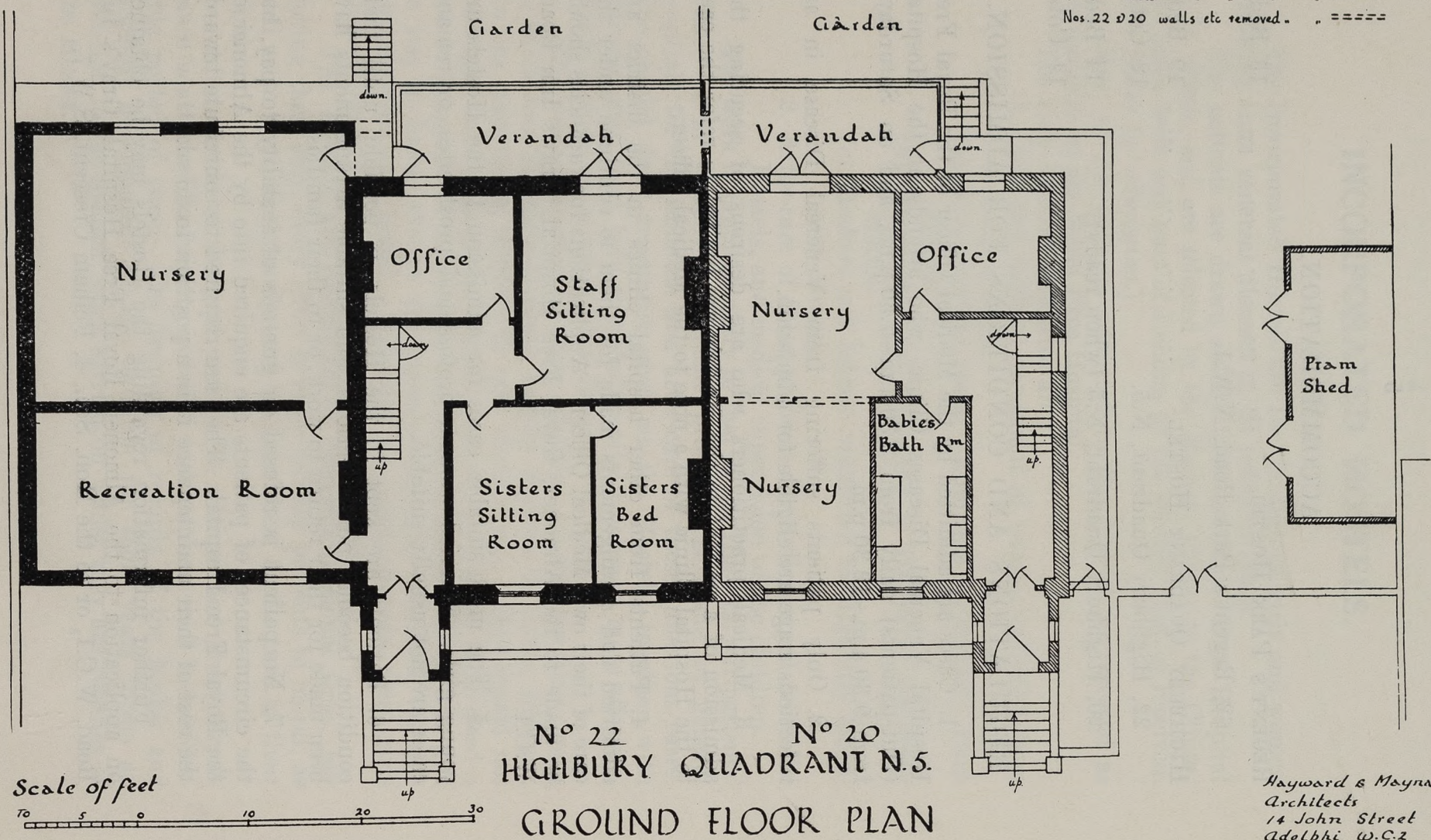

REFERENCE
 No. 22 Existing walls etc shown thus 
 " " New " " " " 
 " 20 Existing " " " " 
 " " New " " " " 
 Nos. 22 & 20 walls etc removed " " 



N^o 22 N^o 20
 HIGHBURY QUADRANT N.5.
 GROUND FLOOR PLAN

Hayward & Maynard
 Architects
 14 John Street
 Adelphi W.C.2

N^{os} 20 & 22 HIGHBURY QUADRANT N.5.

REFERENCE
 No. 22 Existing walls etc shown thus 
 " " New " " " " 
 " 20 Existing " " " " 
 " " New " " " " 
 Nos. 22 & 20 walls etc removed " " 

HAYWARD & MAYNARD
 ARCHITECTS,
 14 JOHN STREET
 ADELPHI, W.C. 2.

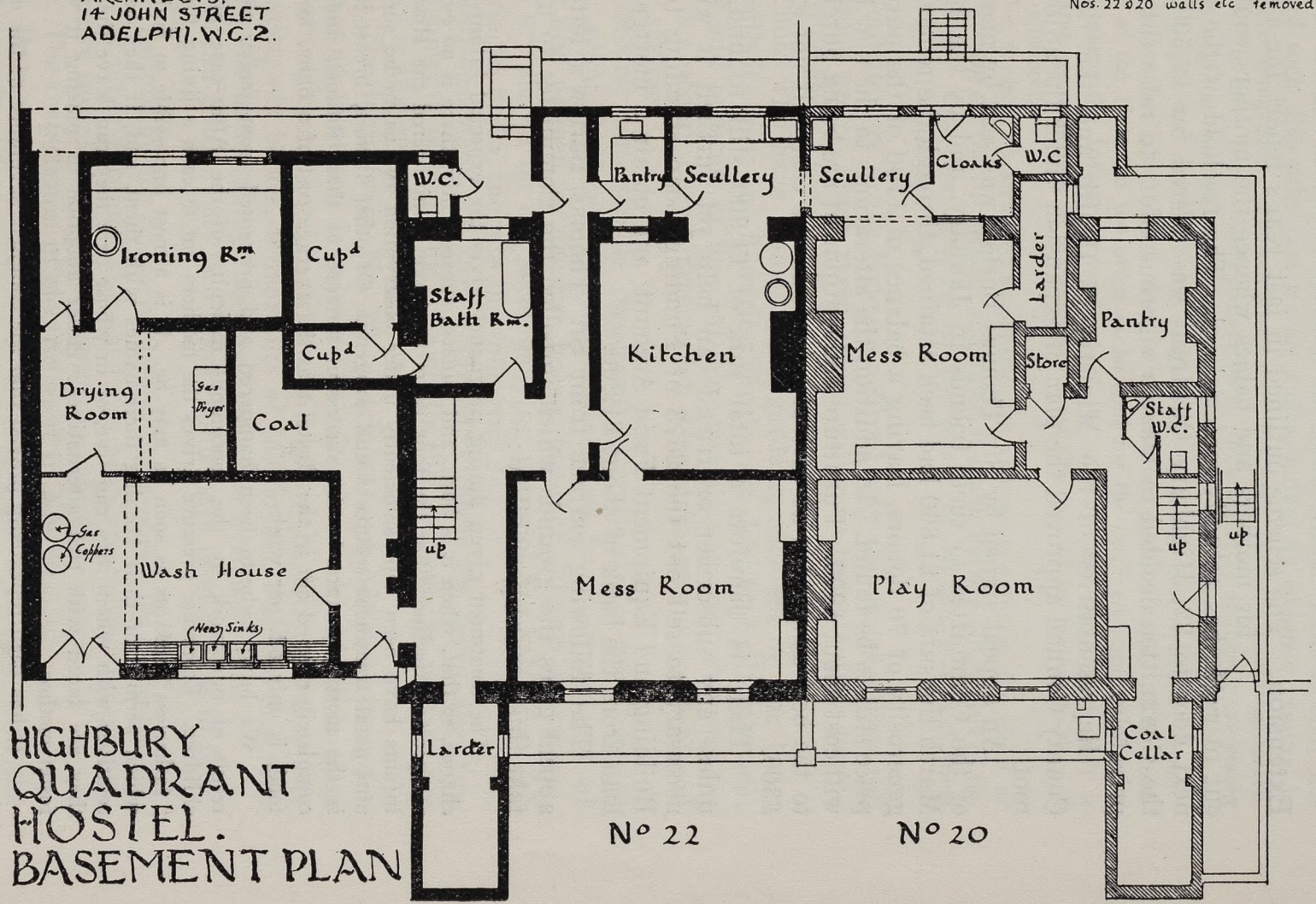

HIGHBURY
 QUADRANT
 HOSTEL.
 BASEMENT PLAN

REPORT

for the year ended March 31st, 1929.

Extension. The scheme outlined in last year's report for a home for mothers and babies whence the mothers could go out to work, has actually materialised. The freehold of the house next door to 22, Highbury Quadrant was offered for £2,500, and the Committee decided to make a vigorous effort to raise this sum privately.

Representatives of the Ministry of Health and the London County Council approved the plan of expansion under the adjoining roof.

An appeal signed by Sir Thomas Barlow was sent by members of the Committee to their friends in January, and by the end of March the sum of £1,800 had been attained, through the remarkable generosity of 70 donors, leaving a balance of £700 of the purchase price still to be found. In addition the alterations to the new house will cost about £900. Furniture and equipment are being purchased to the best advantage at various sales, and the cost will not exceed £300.

There is therefore a total sum of £1,900 still to find, and unless any subscriber or friend can help yet further, it will be necessary to sell out the £673 of Funding Loan standing to the Building and Equipment Fund Account, and obtain a mortgage or loan from the bank of about £1,200.

The following extract from Sir Thomas Barlow's letter of appeal gives the grounds which impelled the Committee to undertake this new responsibility :

The treatment given during pregnancy gives the expected infant a real chance, so that, when it is born, and, indeed, subsequently, there is no evidence of specific infection. For the four years we have administered the Hostel the infants have been kept sufficiently under observation for us to be sure that ante-natal treatment secures sound progeny. Of other factors, breast-feeding is the most important in the successful nurture of these infants, and is so completely carried out in the Hostel that the average cost of a baby, for other food, is only 6d. per week.

We have hitherto been hampered and prevented from seeing the full result of our work by the continuous difficulty of the After-care of these children. Economic pressure drives the mothers out to earn a living for their "fatherless" infants as soon as may be. It is almost impossible to find work which permits of their keeping their babies with them, and, if they have no relatives with whom they can live, or in whose care they can leave the child, they are faced with two alternatives: either adoption or placing it with a foster-mother.

It has been repeatedly proved that the complete severance of the natural tie, by adoption, is likely to lead the mother to return to an undesirable mode

of life, and that, as long as her baby is dependent on her for care and love, she will not "go wrong." Our own experience confirms this statement.

The second alternative (placing an infant with a foster-mother) has presented such difficulties that we are endeavouring, by our new venture, to eliminate it altogether. Though great care has been taken in selecting foster-mothers, few have been wholly satisfactory. The majority of these very young children begin to lose ground soon after they leave the Hostel, and often have to be removed and another home sought. Even at the best, when a "good" foster-mother has been found, there are inevitable disadvantages. The fresh air life of the Hostel is too often exchanged for the confined atmosphere of a close kitchen, the infant is deprived of its natural food at far too early a stage, and, greatest loss of all, it passes from the care of its mother to that of a paid stranger.

We cannot too strongly emphasize the enormous value to the child of breast-feeding for the full period, and unless it can be carried out, a part of the time, money and care lavished on the infant at Highbury Hostel must inevitably fall to the ground.

Contributors to the Extension Fund may feel satisfied that the conditions under which these babies will now pass another twelve months of their lives are in every way excellent.

Those who have seen the two gardens, enclosed by fine trees, each with its lawn and flowering shrubs, are delighted with the real beauty and pure air of this out-door nursery; and for wet weather there is a roomy open-air verandah where the cots may be placed under shelter.

Indoors, considerable structural alterations are being carried out to adapt the house for its purpose, and to effect economy of labour and upkeep for the two houses together. These alterations, which are shown on the accompanying plans of the half-basement and ground floors, include the following :

Half-basement. 1. An enlarged kitchen to serve the two establishments is made by a break in the wall, and a part of the scullery is adapted as a cloak-room.

2. The laundry in No. 22, which was not adequate even for the existing numbers, is enlarged to take the work of both houses. The washing done there, in future, will be for the thirty-three adults and twenty-six babies, inhabitants of the houses, and for this very considerable undertaking increased facilities were essential.

Ground Floor. 3. Two large rooms have been united to form a nursery.

4. Adjoining the nursery a babies' bathroom has been installed.

5. A large perambulator-shed has been erected in the garden. Other improvements not shown on the plans are :

6. The installation of electric light in No. 20.

7. Provision of swing doors on every floor to comply with the Fire Escape Regulations required by the London County Council.

8. Extensive re-decorations.

This work will be completed in June at the time the report goes to press.

The first infants to be accepted for the new home are twin boys, Jock and Sandy, whose mother has been at the Hostel some months. She feels that it is not right to separate twins, nor does she wish to part from them herself. Adoption of the boys by strangers would have been their fate had this home not been available.

Provident Scheme. The Committee, with the cordial co-operation of the staff, have taken up a Provident Scheme on very favourable terms with the Alliance Assurance Company, the basis being 10 per cent. of salaries and emoluments, the employer paying $7\frac{1}{2}$ per cent. and the employee $2\frac{1}{2}$ per cent. Each member of the staff will thus have a small annuity she can look forward to on her retirement. Alternatively, on leaving the Hostel after not less than two years' service she can carry on her policy to her new work, or receive the accumulated premiums, plus 3 per cent. compound interest, in a cash payment. New members of the staff do not become eligible for participation in the scheme until they have completed six months service. The increase in the cost of salaries for this year occasioned by the scheme is £70.

Many hospitals and large employers of labour are encouraging their employees to thrift by this method, and the Committee of the Incorporated Hostels desired to be amongst the first of the smaller institutions to help their staff to provide for the future.

Administration. Both at Regent's Park and Highbury, the usual medical and social work has been carried on, as in previous years. A greater number of weekly classes have been held than hitherto, and the patients themselves have on several occasions planned small entertainments and surprises for the staff. It is also noteworthy that none of this year's patients have discharged themselves hastily.

The Committee have now a part-time after-care worker in connection with each Hostel. They have also been fortunate in securing Mrs. Arnold Paterson as Hon. Secretary to Highbury Hostel, and her able work on administrative details is proving of great value.

The Hostels are always dependent on the co-operation of the Medical Officers of the V.D. Clinic, and that of the Almoners, and it is greatly due to their care and interest in the selection of suitable cases for admission that it is possible for the staff to weld together into a harmonious whole the varying elements in the houses throughout the year.

REGENT'S PARK HOSTEL.

Details of the Year's Work.

On April 1st, 1928, there were thirteen patients in residence at the Hostel. During the year forty-two have been admitted, of whom thirteen were still in residence on March 31st, 1929. The total "patient days" is 3,878, the average length of stay being seventy days.

Staff. Though there have been various changes on the staff this year, all have succeeded in co-operating loyally with Mrs. Bolton, Sister-in-charge, in disinterested work for the benefit of the young women, and are to be congratulated on the pervading friendly atmosphere.

Patients. For the past two years the average length of stay has been greater, and there have been fewer cases admitted for a day or two, and then discharged as unsuitable or unwilling to stay. Apart from medical reasons it is certainly advisable that the majority of patients should stay for some time, if their mental outlook is to be altered. But a residence of four to six months in a Hostel may not in every case be desirable for the non-pregnant patient. She tends to become either stale or bored or swollen-headed, or she may feel that the restrictions have become unbearable; hence careful watching is needed to time her transfer to normal working life at the psychological moment. One or two disheartening incidents have occurred this year, when patients who had spent months at the Hostel, apparently accepting its lessons and enjoying its privileges, have left, only to revert almost immediately to bad companionship.

On the other hand, several impatient girls and unruly young women have settled down quite satisfactorily at home or in service, and some of the long stay patients have proved very rewarding. For instance, F., who had spent just a year passing from the Hostel to hospital, convalescent homes and back again with very protracted physical illness, has proved herself worthy of confidence and is now holding a position of trust.

The Committee are most grateful to those who have given up an afternoon every week to instruction or games at the Hostel. A course of citizenship from a County Council teacher has been popular. At one time there was a strong demand for lessons in French, which were given for about eight weeks, but owing to the

constant coming and going of patients a continuous course of lessons is almost impossible. The leading spirit, whoever she may be, usually sets the taste, but First Aid and "General Knowledge" seem to be permanently in favour.

The wireless set generously given by Mrs. Cadbury last year has proved an unending source of pleasure both to staff and patients.

Medical Report.

From Dr. Margaret Rorke, Chief of Female V.D. Department, Royal Free Hospital:

During the past year the Hostel has been almost continuously filled with girls. Many of these were from the Royal Free Clinic, but a considerable number came from the country or from other clinics. They were of all ages and types, some very young. Two cases, when admitted from other clinics on a medical certificate of V.D., were found on examination to be pregnant, and on that account one was transferred to Highbury Hostel and the other to Parkhurst Road (West London Mission).

Medically the cases were much as in former years. A few of the syphilis cases were very virulent infections, but were mostly tolerant of the necessarily intensive treatment, and no toxæmias resulted. Cases of acute gonorrhoea required considerable rest and care in addition to their purely venereal treatment: but such case are far preferable to the old-standing chronic gonorrhoeas which are found in some of the girls, who from ignorance or carelessness have neglected treatment in the early stages of the disease. The tedium and length of time required for their successful treatment tries the patience of medical staff and patient alike: but perseverance till complete cure is established is essential, if freedom from infectivity is to be obtained, and complications and sequelae avoided.

I have once again to render hearty thanks on behalf of the medical staff of the Royal Free Hospital V.D. Department, to Mrs. Bolton and her staff for loyal co-operation and for their untiring efforts on the patients behalf, morally, mentally and physically.

MARGARET RORKE.

After-Care. Constant visiting, sometimes far afield, is required to keep in close touch with those patients who have only recently left the Hostel. Mrs. Bolton found that she was unable to do as much of this, as she considered necessary, and at the same time give the inmates of the Hostel her full attention, so the Committee have recently engaged the services of Miss Mance of St. Margaret's House, Bethnal Green, as After-Care Visitor. It being essential that Miss Mance should be on friendly terms with the girls before they leave, she spends one afternoon a week playing games or reading with them, in order to get to know them and be able to help them later on.

An Old Girls Party was held at the Hostel at Christmas time, when over forty sat down to supper, each place being marked by a name-card "like a real dinner." It was a satisfaction to see the peaceful settled look on many of the faces, and to hear of four or five years spent in one situation.

The figures on After-care given below show a considerable increase on last year, when during five months there had been no permanent head to the Hostel.

	1926	1927	1928
Letters received from Old Girls ...	283	159	218
Letters written to Old Girls ...	291	167	254
Visits from Old Girls ...	498	190	202
Visits to Old Girls ...	12	40	22
Letters from employers or workers ...	461	212	198
Letters to employers or workers ...	545	340	246
Visits from employers or workers ...	242	169	111
Visits to employers or workers ...	13	26	32

Of those who have passed through the Hostel in the last ten years, 407 are now considered unlikely to need help, and have been tabulated as such in the figures given on page —.

Finance. The income for the year shows an expansion as compared with 1927-28 from £1,382 2s. 1d. to £1,466 5s. 4d., a fall in dividends and interest received being more than compensated by an increase in subscriptions and donations, and payments by or on behalf of patients (including receipts from approved societies).

Expenditure has also risen from £1,387 3s. 11d. to £1,457 8s. 11d., for which an increased charge for repairs and renewals is responsible. In other respects the individual items of expenditure are much upon the lines of last year's figures.

The net result is a surplus for the year of £8 16s. 5d., as compared with a deficiency for the last year of £5 1s. 10d. The management of the Hostel has to exercise the greatest care each year to keep the expenditure within the limits of probable income. A development of the subscription list is therefore much to be desired.

Thanks. The Committee wish to express their thanks to all subscribers and donors and to the following for their most generous gifts in kind:

Mrs. Cadbury. Wireless set.

Mrs. James Beale and Miss H. M. Beale for a constant supply of flowers, and for fruit and vegetables.

Flowers and plants have also been sent by: Mrs. Bush, Miss Brooke, Miss Lever, the Old Girls, Miss Mance, Miss Shackleton, Mrs. Thring, and Miss Thring.

Clothing. Miss Crockett, Miss d'Avigdor, Miss Edwards, Miss Hall, Dr. Hare, Miss Legge, Miss McEwan, Mrs. McClintock, Miss Oakley, Miss Lever, Miss Paul, Miss Rhodes, Mrs. Thring, and Dr. Rorke.

Christmas Presents. Miss H. M. Beale, Miss d'Avigdor, Dr. Gourlay, Mrs. Green, Dr. Hare, Dr. Rorke, Miss Samuel, the Staff, three Old Girls, Mrs. Smeathman, Messrs. Griffith, Joyce, Perry, and Thomas.

Theatre and Zoo Tickets. Miss H. M. Beale, Dr. Hare, Mr. T. Huxley, Miss Royden, Lady Thring, and the Royal Free Hospital.

REPORTS ON PAST PATIENTS.

Requiring After-Care.

Satisfactory	36	
Handed to other workers or in homes	33	
Married	2	
Doubtful or fair	10	
Lately lost, thought unsatisfactory ...	3	89
	—	

No more After-Care needed.

Satisfactory	171	
Lost sight of, thought satisfactory ...	72	
Married	27	
M.D. certified	9	
Died	4	
Unsatisfactory	70	
Lost sight of, thought unsatisfactory ...	54	407
	—	—
Total passed through Hostel, 1919-29		496

OCCUPATIONS AND DISPOSAL OF PATIENTS

for year ended March 31st, 1929.

	In Hostel Mar. 31/28.	Admitted 1928-29.	Discharged 1928/29.	In Hostel Mar. 31, 1929.
Domestic	8	14	19	3
Factory	3	14	7	6
Nursery Governess		2		1
Clerk		1	1	
Mental Nurse		1		1
Waitress	1	2	3	
Married woman		2	2	
Living at home		1	4	
School		3	1	
Prostitute		1		
Other homes	1		5	
Mentally deficient, placed under certificate		1		1
	—	—	—	—
	13	42	42	13

HIGHBURY QUADRANT HOSTEL.

Details of the Year's Work.

There have been thirty-nine patients admitted to Highbury Hostel this year, and thirty-three babies have been born, the patients being transferred for their confinement to the Royal Free Hospital. The number of "Patient Days" is 5,362, and of "Baby Patient Days" 3482.

Staff. One or two changes are to be reported on the staff this year. Sister Baker, the second-in-command, resigned, to the great regret of the Committee, as she desired to take a post as Sister-in-charge. Her place has been ably filled by Sister Gower, who had undertaken holiday duty at the Hostel during the summer. The staff, senior and junior, work harmoniously under Sister Noakes, whose unfailing devotion to the Hostel continues. Mrs. Watson, the kitchen-matron, not only excels in her own department, but is always ready to help with the girls' entertainments.

Patients. During their stay at the Hostel the patients receive training in house-work, and the additional training in kitchen-work and cooking given to some of them by the kitchen-matron greatly increases their prospects of obtaining good posts as domestics.

To teach the mothers to care for and to feed their infants is one of the special features of the Hostel.

At Christmas-time the patients sent out invitations to a musical party, and the carols, glees and part songs which they sang were proof of the excellent instruction they had had from Mrs. Marsh, a London County Council teacher.

Medical Officer's Report.

From Dr. A. R. Campbell, M.B., Ch.B., Medical Officer Highbury Hostel.

The health of the mothers and babies at 22, Highbury Quadrant has been very good. From the point of view of illness it has been an uneventful year. All the thirty-three babies have been full-time infants, and there has been no still-born child or any death.

Six patients were admitted during pregnancy suffering from syphilis. These attended the hospital for treatment, and in each case the baby was born at full-time and healthy. The Wasserman test of each child was taken a month after birth, and all tests were negative.

The mothers are encouraged to breast-feed their babies, and where there is insufficient milk a supplementary feed of cow's milk is given.

Fortunately all those suffering from syphilis have been able to breast-feed their infants, the further treatment given to the mothers after confinement ensuring the child's treatment through the medium of the breast-milk.

The Hostel continues to hold quarterly parties for the mothers and babies who have left. The mid-summer party is the greatest success from the point of view of attendance. The children who come to these parties are all examined by me. All are doing well, and very little cod-liver oil has been needed for distribution this year, which is, I think, a tribute to the good start in life they get at 22, Highbury Quadrant

A. R. CAMPBELL, Medical Officer.

After-Care. As will be seen from the figures given below, the number of visits from the Old Girls is rather less than last year. The severity of the winter probably accounts for this slight decrease. To balance it, there has been an increase in letters. At the spring Old Girl's party one young woman brought with her from the country, three sturdy, rosy children, one being her own, the two others she is fostering for Highbury mothers. She had left at home a fourth infant, and is bringing up this family of foster-children with great success. It is pleasant to relate the following incident about one of them. Colin, an attractive baby taken by E.D. to foster, had been abandoned by his own mother, and she ceased her weekly payments for him: it therefore seemed impossible for E.D. to keep him, and the Committee advised her to hand him over to the Guardians. Miss McEwan, Almoner of the Royal Free Hospital, went down with two friends to the girl's home to tell her of this decision. E.D. was greatly distressed at the idea of parting from Colin, and the two friends were so touched by her sorrow that they have undertaken to pay for Colin's keep until he is fourteen, so that he may remain with his foster-mother.

	1926	1927	1928
Visits from Old Girls	288	378	313
Letters from Old Girls	187	211	281
Letters to Old Girls	145	148	177
Letters from employers or workers ...	207	190	207
Letters to employers or workers ...	261	226	269

Finance. Mention has been made earlier in the report of the capital outlay on the new home.

As regards the current account of 22, Highbury Quadrant, the expenditure is the lowest on record, but the number of patient days is also slightly smaller than usual.

The complete total cost of each patient has been £2 7s. per week. This includes salaries, rent, rates, repairs to house, food and general upkeep. The average weekly cost of food per head is 9/6 for adults and 6½d. for babies.

The Committee desire to express their gratitude to those donors who have so generously helped to buy the new house, to the subscribers whose regular support encourages them year by year, and to the following for their gifts :

Tickets for entertainments. The Lady Emmott.

Furniture and Equipment. Miss Smith, Miss James, and Miss d'Avigdor.

Perambulator. Miss Culverwell.

Clothing. The Hon. Mrs. Barlow, Mrs. Sidney Higgs, Dr. Hare, Mrs. Jackson, Mrs. and Miss Pook, Mrs. White, Queen Mary's Needlework Guild.

Fruit, Flowers and Plants. Dr. Campbell, Mrs. Henriques, Miss E. Deacon, Highbury Congregational Bible Class, and Miss E. M. Royden.

Christmas Gifts. The Hon. Mrs. Barlow, Dr. Campbell, Miss d'Avigdor, Mrs. Julian Q. Henriques, Miss Meadowcroft, Mrs. Arnold Paterson, Miss Pook, Dr. Rorke, Mrs. White, and Messrs. Toop and Welford.

OCCUPATIONS OF PATIENTS ADMITTED TO HIGHBURY HOSTEL during the year 1928-29.

Domestics	24
Clerks	3
Shop Assistants	3
Waitresses	2
Factory Hands	2
Dressmaker	1
Hairdresser	1
Nurse	1
Married Woman	1
									—
									39

After History :

Transferred to other Homes	10
Transferred to Hospitals...	2
Returned to their own homes	11
Domestic service	12
Clerks	2
Lady's Maid	1
Nurse	1
									—
									39

Disposal of Infants :

Living with mothers	11
Living with foster-mothers	11
Living with friends or relatives	5
Sent to Homes...	4
									—
									31

REPORTS ON PAST PATIENTS.

	Recent News.	No Recent News.	Total.
Satisfactory	58	8	66
Married	12	12	24
Fair or doubtful	6	2	8
Unsatisfactory	5	10	15
Died	3
Handed over to other Homes	7	32	39
Lost sight of	18
Emigrated	2	...	2
In residence in Hostel	18
			—

Total for the years 1925-29 ... 193

	Donations.			Subs.		
	£	s.	d.	£	s.	d.
Hare, Miss K. C.				10	0	0
Johnson, W. C., Esq.				1	1	0
Kekewich, Miss Hilda					10	6
Kerr, Mrs. Mark				2	0	0
King, Dr. C. A.				1	1	0
Leyland-Barratt, Sir Francis				5	5	0
Levy, Mrs. Goodman				1	1	0
Levy, The Hon. Mrs. Walter				2	2	0
Mackenzie, Miss E. Muir				10	0	0
Mackinnon, Mrs. Duncan	1	0	0			
Marker, Miss E. M.				3	3	0
McIlroy, Professor Louisa				2	0	0
Mellor, Miss J. V.				4	0	0
Melville, Beresford V., Esq.				2	2	0
Moon, Mrs. Edward				1	1	0
Moro, Arthur R., Esq.	1	1	0			
Morris, Dr. F. M., O.B.E.				1	1	0
Nathan, Sir Mathew, K.C.M.G.				1	0	0
Pemberton, Miss E. B.					5	0
Penfold, Miss (two years)				6	0	0
Phear, Dr. A. G., C.B.	2	2	0			
Phipson, H. M., Esq.				10	0	0
Plender, Lady				1	1	0
Prideaux & Webbey, Messrs.	104	0	0			
Pulteney, Dr. I.				2	2	0
Richardson, Mrs.				2	2	0
Rorke, Dr. Margaret				1	1	0
Royden, Miss E. M.				3	3	0
Russell, Mrs. Charles				1	1	0
Salaman, Mrs. Meyer				1	1	0
Sanderson, Dr. Clow				2	2	0
Sebag-Montefiore, The Hon. Mrs. R.				2	2	0
Sellar, Mrs. Craig				3	3	0
Simeon, Ella Lady	4	0	0			
Shaw, Robert Norman, Esq.,				8	0	0
Shaw, Mrs. Norman				2	0	0
Spielman, Lady				1	1	0
Spooner, The Rev. Dr.	2	2	0			
Thorne, Dr. May				3	0	0
Waldy, Mrs.				1	0	0
Welsh, Miss J. S. O'Donnell				2	2	0
Williams, Miss E.		5	0	0		
Valpy, Mrs.		2	2	0		
Vickers, Cecil, Esq.				2	2	0
<hr/>						
£137 18 0 230 4 6						

List of Subscribers to Highbury Quadrant for the year ended March 31st, 1929.

	£	s.	d.
Beevor, Mrs.	3	3	0
Blackburne, Miss G. M. Ireland		5	0
Browne, Miss A. B.	1	0	0
Brunner, Lady	2	2	0
Campbell, Dr. A. R.	1	1	0
Darwin, The Hon. Lady	1	0	0
Dawkins, The Lady Bertha	1	1	0
Denne, Mrs.	1	0	0
Emmott, The Lady	1	1	0
Hare, Miss K. C.	10	0	0
Lascombe, Miss		2	6
Lewis, Mrs.	1	1	0
Nichollette, Mrs.	1	1	0
Orred, Miss A. K.	1	1	0
Pilcher, Giles T., Esq.	2	2	0
Rorke, Dr. M.	1	1	0
Rowe, Mrs. and Miss Ewart	1	0	0
St. Cyres, The Viscountess	2	2	0
Sydenham, The Lord and Lady	5	0	0
Wallace, Miss Jessie	2	0	0
Wilson, Dr. Helen		10	0
Wilson, Mrs.	1	1	0
<hr/>			
£39 14 6			

**THE INCORPORATED HOSTELS associated
Balance Sheet,**

Dr.

	£	s.	d.	£	s.	d.
To SUNDRY CREDITORS:—						
Regent's Park	158	12	10			
20, Highbury Quadrant	16	13	11			
22, Highbury Quadrant	128	0	8			
				303	7	5
„ RESERVE FOR REPAIRS, 22, Highbury Quadrant ...				200	0	0
„ LOAN ON MORTGAGE OF LEASEHOLD PROPERTY:—						
62, Regent's Park Road, N.W.				1,000	0	0
„ SPECIAL FUNDS ON CAPITAL ACCOUNT:—						
<i>for Building and Equipment: Regent's Park</i>						
Balance 1st April, 1928	1,452	8	9			
<i>for Building and Equipment: 22, Highbury Quadrant</i>						
Balance 1st April, 1928	1,206	13	4			
<i>for Building Equipment: 20, Highbury Quadrant</i>				1,788	4	5
<i>for General Purposes: Regent's Park</i>						
Balance 1st April, 1928				500	16	8
„ ENDOWMENT FUND:—						
<i>Highbury Quadrant</i>						
Balance 1st April, 1928	300	0	0			
Add transfer from Income and Expenditure Account..	200	0	0			
				500	0	0
„ INCOME AND EXPENDITURE ACCOUNT:—						
<i>Regent's Park</i>						
Balance 1st April, 1928	277	1	6			
Add Excess of Income over Expenditure for the Year	8	16	5			
				285	17	11
<i>Highbury Quadrant</i>						
Balance 1st April, 1928	590	19	0			
Add Excess of Income over Expenditure for the Year	155	18	9			
				746	17	9
Less transferred to Endowment Fund	200	0	0			
				546	17	9
„ BANK OVERDRAFT:—						
20 Highbury Quadrant/Freehold Property Account...				601	10	4
				£8,385	16	7

To the Members of the Incorporated Hostels associated with
The Royal Free Hospital.

We have audited the above Balance Sheet, and have obtained all the information and explanations we have required. The amount to the credit of the Income and Expenditure Account includes the balance, on that account as at the date of the Incorporation of the Company, viz:—27th day of February, 1926. Subject to the foregoing remark the said Balance Sheet is, in our opinion, properly drawn up so as to shew a correct view of the state of affairs of the Company, according to the best of our information and the explanations given us, and as shewn by the books of the Company.

DATED THIS 1ST DAY OF JUNE, 1929.

**with THE ROYAL FREE HOSPITAL.
31st March, 1929.**

Cr.

	£	s.	d.	£	s.	d.
By CASH AT BANK:—						
Deposit Account—Regent's Park ...	250	0	0			
Highbury Quadrant...	200	0	0			
				450	0	0
Current Account—Highbury Quadrant...	24	6	4			
Cash „ Regent's Park ...	16	14	5			
				41	0	9
„ CASH IN HAND:—						
Regent's Park	16	3	8			
Highbury Quadrant	9	15	8			
				25	19	4
„ INVESTMENTS:—						
<i>Regent's Park</i>						
£501 8s. 3d. War Stock 5% 1929/47 (on General Purposes Account)	500	16	8			
600 National Savings Certificates (on Leasehold Sinking Fund Account) ...	480	0	0			
				980	16	8
<i>Highbury Quadrant</i>						
£673 7s. 6d. Funding Stock 4% 1960/90 (on Building and Equipment Fund A/c) ...	554	16	9			
£565 2s. 6d. Funding Stock 4% 1960/90 (on Endowment Account)	500	0	0			
				1,054	16	9
				2,035	13	5
„ FREEHOLD PROPERTY:—						
22, Highbury Quadrant, N. 5				651	16	7
20, „ „ Expenditure to date				2,552	10	0
				3,204	6	7
„ LEASEHOLD PROPERTY:—						
62, Regent's Park Road, N.W. (subject to Mortgage as <i>per contra</i>)	2,386	10	6			
Deduct Provision by Sinking Fund for Amortisation of Lease	480	0	0			
				1,906	10	6
„ FURNITURE AND EQUIPMENT:—						
Regent's Park, as at 31st March, 1928 ...	65	18	3			
20, Highbury Quadrant, Expenditure to date	103	18	8			
				169	16	11
„ SUNDRY DEBTORS:—						
Regent's Park	161	12	8			
Highbury Quadrant	390	16	5			
				552	9	1
				£8,385	16	7

1833 Fully Paid Shares of One Pound each of the Rembau Jelei Rubber Limited, are held on behalf of the Hostels by a third party. The dividends declared thereon during the period under review have been included in the Income and Expenditure Account.

HARDY, HISLOP & Co.

Chartered Accountants,

119, Moorgate,

London, E.C. 2.

} Auditors.

REGENT'S PARK
Income and Expenditure Account for the

INCOME.	1928.		1929.	
	£	s. d.	£	s. d.
Annual Subscriptions	200	8 0	230	4 6
Donations	147	1 0	137	18 0
Dividends and Interest	229	19 5	78	10 4
Payments by and on behalf of Patients	155	15 4	241	5 6
" " Approved Societies	48	18 4	78	7 0
Grant—Ministry of Health	600	0 0	700	0 0
Balance, being Excess of Expenditure over Income	5	1 10		

£1,387 3 11 1,466 5 4

HOSTEL.
Years ended 31st March, 1928 and 1929.

EXPENDITURE.	1928.		1929.	
	£	s. d.	£	s. d.
Maintenance.				
Provisions—				
Meat	60	1 0	65	13 0
Fish, Poultry, etc.	21	7 10	14	14 4
Butter, Bacon, etc.	32	8 10	48	11 3
Eggs	11	13 1	11	0 2
Milk	46	13 5	45	14 6
Bread, Flour, etc.	30	11 4	31	15 6
Grocery	63	19 3	78	11 3
Vegetables and Fruit	50	7 10	51	14 10
		317 2 7		347 14 10
Surgery and Dispensary—				
Drugs, Chemicals, Disinfects, &c.	7	13 3	16	0 11
Dressings, Bandages, etc.	—	—	2	10
Instruments and Appliances	4	12 6	7	11 3
		12 5 9		23 15 0
Renewals and Repairs—				
Furniture	65	0 5	37	15 9
Bedding and Linen	10	1 1	9	15 1
Hardware, Brushes, &c.	21	15 4	11	13 10
		96 16 10		59 4 8
Fuel and Lighting—				
Coal	33	13 0	33	9 11
Gas	57	3 6	57	18 3
Electric Current	23	5 2	20	11 0
Oil, Wood, etc.	—	—	12	11
		114 1 8		112 12 1
Domestic—				
Washing	43	16 9	54	0 6
Cleaning and Chandlery	22	17 5	25	11 5
Water	4	7 1	4	7 1
Uniforms	14	0 0	7	19 7
		85 1 3		91 18 7
Establishment—				
Insurance	7	6 4	7	11 9
Renewals and Repairs	49	13 4	139	18 9
		56 16 8		147 10 6
Salaries and Wages		433 11 5		398 19 10
Miscellaneous—				
Printing and Stationery	19	3 7	24	10 0
Postage	22	12 4	27	19 10
Fares	23	9 1	24	0 3
Education	8	0 0	—	—
After-care	1	4 8	6	0 10
Advertisement	1	7 0	4	0
		75 16 8		82 14 11
Total Cost of Maintenance		1,191 15 10		1,264 10 5
Auditors' Fee		5 5 0		5 5 0
Rent		17 10 0		17 10 0
Rates and Taxes		37 2 7		35 3 6
Interest on Mortgage		55 0 0		55 0 0
Leasehold Sinking Fund		80 0 0		80 0 0
Law Charges		10 6		—
Balance, being excess of Total Income over Total Expenditure		—		8 16 5
		<u>£1,387 3 11</u>		<u>£1,466 5 4</u>

HIGHBURY QUAD

Income and Expenditure Account for the

INCOME.	1928.			1929.		
	£	s.	d.	£	s.	d.
Annual Subscriptions	51	16	0	39	14	6
Donations	42	1	0	—	—	—
Dividends and Interest	235	2	9	93	5	7
Payments by and on behalf of Patients	273	2	9	331	12	3
" " Approved Societies	110	17	4	94	6	0
Grant—Ministry of Health	1,500	0	0	1,400	0	0
	<u>£2,212</u>	<u>19</u>	<u>10</u>	<u>£1,958</u>	<u>18</u>	<u>4</u>

RANT HOSTEL.

Years ended 31st March, 1928 and 1929.

EXPENDITURE.	1928.			1929.		
	£	s.	d.	£	s.	d.
Maintenance.						
Provisions—						
Meat	88	4	1	75	9	1
Fish, Poultry, etc.	29	9	2	31	19	3
Butter, Bacon, etc.	82	18	1	77	17	5
Eggs	18	5	0	23	9	7
Milk	108	9	5	104	7	1
Bread, Flour, etc.	65	13	5	51	3	4
Grocery	75	8	7	79	12	0
Vegetables and Fruit	73	2	10	75	10	9
	<u>540</u>	<u>10</u>	<u>7</u>	<u>519</u>	<u>8</u>	<u>6</u>
Surgery and Dispensary—						
Drugs, Chemicals, Disinfects, etc.	7	19	9	18	4	7
Dressings, Bandages, etc.	4	18	1	5	15	5
Instruments and Appliances	2	17	6	7	10	7
	<u>15</u>	<u>15</u>	<u>4</u>	<u>31</u>	<u>10</u>	<u>7</u>
Renewals and Repairs—						
Furniture	36	7	4	33	3	10
Bedding and Linen	19	14	3	33	7	11
Hardware, Brushes, etc.	20	7	0	18	3	7
	<u>76</u>	<u>8</u>	<u>7</u>	<u>84</u>	<u>15</u>	<u>4</u>
Fuel and Lighting—						
Coal	55	2	10	51	3	3
Gas	42	4	9	40	6	2
Electric Current	16	10	0	18	3	3
Oil, Wood, etc.	2	16	2	1	6	9
	<u>116</u>	<u>13</u>	<u>9</u>	<u>110</u>	<u>19</u>	<u>5</u>
Domestic—						
Washing	12	1	2	15	1	9
Cleaning and Chandlery	33	7	7	37	8	9
Water	5	17	6	5	17	6
Uniforms	7	1	4	19	0	0
Sundries	2	3	2	2	0	0
	<u>60</u>	<u>10</u>	<u>9</u>	<u>61</u>	<u>7</u>	<u>0</u>
Establishment—						
Insurance	8	16	11	8	17	0
Renewals and Repairs	350	6	11	192	19	0
Garden	8	9	6	5	16	1
	<u>367</u>	<u>13</u>	<u>4</u>	<u>207</u>	<u>12</u>	<u>1</u>
Salaries and Wages	527	6	4	611	18	8
Miscellaneous—						
Printing and Stationery	12	6	0	17	0	0
Postage	22	2	6	23	18	1
Fares	38	10	7	30	8	5
Education	6	17	9	5	4	11
After-care	32	12	1	43	19	1
Entertainment	5	0	0	5	0	0
	<u>117</u>	<u>8</u>	<u>11</u>	<u>125</u>	<u>10</u>	<u>6</u>
Total Cost of Maintenance	1,823	7	7	1,753	2	1
Law Charges	10	10	0	5	5	0
Auditors' Fee	5	5	0	5	5	0
Rates and Taxes	41	17	6	39	7	6
Balance, being excess of Total Income over Total Expenditure	331	19	9	155	18	9
	<u>£2,212</u>	<u>19</u>	<u>10</u>	<u>£1,958</u>	<u>18</u>	<u>4</u>

RAWT HOSTELING
Year ending 31st March 1928 and 1929

Table with columns for years (1929, 1928) and various financial categories such as 'Expenditure', 'Income', and 'Balance'. The text is oriented vertically on the page.

J. DAVY & SONS., LTD.



8-9, FRITH STREET, W.1.

